

# Vision 1:1 800-2000 VA



## HIGHLIGHTS

- Superior protection
- Compact and contemporary design
- High availability
- Versatility
- LCD display
- Automatic Voltage Regulation (AVR)

The Vision range is available in models from 800 VA to 2000 VA with sinusoidal digital technology. The Vision range, with its advanced communications and connectivity options, is the ideal solution for installations requiring superior protection and versatility in the power supply system. Vision is the ideal solution for the protection of peripheral network devices, servers, and network back-up systems.

## Superior protection

The Vision range uses Line Interactive technology and provides a sinusoidal output. This technology provides efficiency levels of 98% and therefore reduced energy consumption. It also ensures a high level of protection against mains power disturbances. The automatic voltage regulator (AVR)

provides protection from surges, overvoltages and undervoltages, without battery intervention. Reduced battery usage ensures that the battery set is 100% available for mains power supply failures and is able to provide greater autonomy. EMI filters then provide further protection from voltage surges and transients. When the mains power supply fails, the load is powered by the inverter and receives a perfectly sinusoidal supply for maximum power continuity and reliability. With energy savings in mind, the Vision range features a shut-off button to reduce energy consumption to zero during periods of prolonged inactivity.



Hot swap battery



USB plug



SOHO



Plug & Play installation



LINE INTERACTIVE

## High availability

An EnergyShare socket allows load-shedding and the shutdown of less sensitive peripheral devices to extend battery runtime for critical loads. "Hot Swap" batteries can be removed via the front panel for easy and safe UPS maintenance.

Battery test facility to detect deteriorating battery performance. Deep discharge protection to reduce battery ageing.

## Versatility

Cold Start function to allow the UPS to power up with no mains power supply present.

## LCD display

Vision models have a backlit LCD display providing UPS status information, load and battery performance.

## Advanced communications

- Advanced multi-platform communications for all operating systems and network environments: PowerShield<sup>3</sup> monitoring and shutdown software for Windows operating systems 8, 7, 2008, Vista, 2003, XP, Linux, Mac OS X, Sun Solaris, Linux, VMWare ESX and other Unix operating systems
- USB or RS232 serial port interface (selectable)
- Expansion slot for interface boards
- Status, measurements, alarms and input, output and battery parameters available on LCD display.

## Features

- EnergyShare socket
- Ability to switch on the UPS in the absence of mains power (Cold Start)
- Batteries are user replaceable without switching off equipment and without interruption to the load (Hot Swap)
- Maximum reliability and protection of PCs thanks to PowerShield<sup>3</sup> monitoring and shutdown software, which can be downloaded free at [www.riello-ups.com](http://www.riello-ups.com)
- Fully configurable using UPS Tools configuration software
- Highly reliable batteries (automatic and manually-activated battery test)
- Built-in short circuit protection
- Auto restart (when mains power is restored, after discharge of the batteries)
- GS/Nemko safety seal

## 2-YEAR WARRANTY



## AVAILABLE OPTIONS

### SOFTWARE

PowerShield<sup>3</sup>  
PowerNetGuard

### ACCESSORIES

NETMAN 101 PLUS  
NETMAN 102 PLUS  
NETMAN 202 PLUS  
MULTICOM 301  
MULTICOM 302

MULTICOM 351

MULTICOM 352

MULTICOM 372

MULTICOM 382

MULTICOM 401

MULTI I/O

Interface kit AS400

MULTIPANEL

RTG 100

## DETAILS

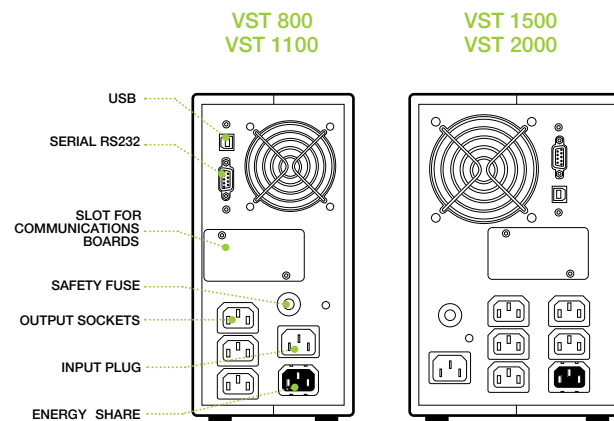

1300 662 435

[poweronaustralia.com.au](http://poweronaustralia.com.au)

Power On Australia Pty Ltd - ABN 48 110 752 442

Unit 20, 256-258 Musgrave Road, Coopers Plains Qld 4108 (Head Office)

Po Box 5322, Daisy Hill QLD 4127

MODELS	VST 800	VST 1100	VST 1500	VST 2000
<b>POWER</b>	<b>800 VA/640 W</b>	<b>1100 VA/880 W</b>	<b>1500 VA/1200 W</b>	<b>2000 VA/1600 W</b>
<b>INPUT</b>				
Nominal voltage	220 - 230 - 240 V selectable			
Voltage tolerance	162 V - 290 V			
Frequency	50/60 Hz with automatic selection			
Frequency tolerance	±5%			
<b>OUTPUT</b>				
Nominal voltage	220 - 230 - 240 V selectable			
Frequency	50 or 60 Hz with automatic selection			
Waveform	Sinusoidal			
<b>BATTERIES</b>				
Type	VRLA AGM maintenance-free lead based			
Recharge time	4-6 h			
<b>OTHER FEATURES</b>				
Net weight (kg)	10.5	11.3	16.5	18.5
Gross weight (kg)	12.2	13	18.4	20.4
Dimensions (WxDxH) (mm)	120 x 443 x 247		160 x 443 x 247	
Packaging dimensions (WxDxH) (mm)	208 x 530 x 342		235 x 540 x 354	
Protections	Overload - short-circuit - overvoltage - undervoltage - temperature - excessive low battery			
Communications	USB / RS232 / slot for communications interface			
Input plugs	1IEC 320 C14			
Output sockets	4 IEC 320 C13		6 IEC 320 C13	
Standards	EN 62040-1-1 and Directive 2006/95/EC EN 62040-2 and Directive 2004/108 EC			
Operating temperature	0 °C / +40 °C			
Storage temperature	-15 °C / 45 °C			
Colour	Black			
Relative humidity	<95% non-condensing			
Noise	< 40 dBA			





DATVSTA1Y13CREN



**1300 662 435**  
[poweronaustralia.com.au](http://poweronaustralia.com.au)

**Power On Australia Pty Ltd** - ABN 48 110 752 442

📍 Unit 20, 256-258 Musgrave Road, Coopers Plains Qld 4108 (Head Office)  
📦 Po Box 5322, Daisy Hill QLD 4127